

## TRAIL103

### CABINET LOUDSPEAKERS

#### *Rail Mount Loudspeaker*



### PRODUCT OVERVIEW

TRAIL103 is a 3" lamp style loudspeaker cabinet, featuring an installation system which is compatible with ceiling light rails, as well as surface mount, truss mount, etc. High Impedance (15W and 30W taps) and Low Impedance (4 ohm) connections included. White and black colours available.

### KEY FEATURES

- 3" driver
- Mounting options (included): ceiling light rails, surface mount and truss mount
- Low impedance connection: 4  $\Omega$
- High impedance connection: 15/30W connections
- Available in white and black finish

- EASE Win file available 

### APPLICATIONS

- Shopping centres
- Retail shops
- PA distributed sound systems
- Clubs, Cafes, Bars foreground/background reinforcement
- Health and sports centres
- Meeting and conference rooms

### TECHNICAL DATA

<b>Ways</b>	1
<b>Driver diameter</b>	3"
<b>Power</b>	15 WRMS / 30 W Program
<b>Power connections</b>	Lo-Z: 4 $\Omega$ ; Hi-Z: 15/30 W @ 100V
<b>Input impedance</b>	4 $\Omega$ /667 $\Omega$ /333 $\Omega$
<b>Frequency response (-10dB)</b>	105Hz - 20 kHz
<b>Sensitivity 1W/1m</b>	83 dB
<b>Dimensions (without arm)</b>	Ø96mm x 110mm
<b>Fixing system</b>	4 wire 3 circuit track system
<b>Support arm</b>	Swivel (pan and tilt)
<b>Connection type</b>	Euroblock terminals
<b>Weight</b>	1.00 kg

MECHANICAL DIAGRAMS

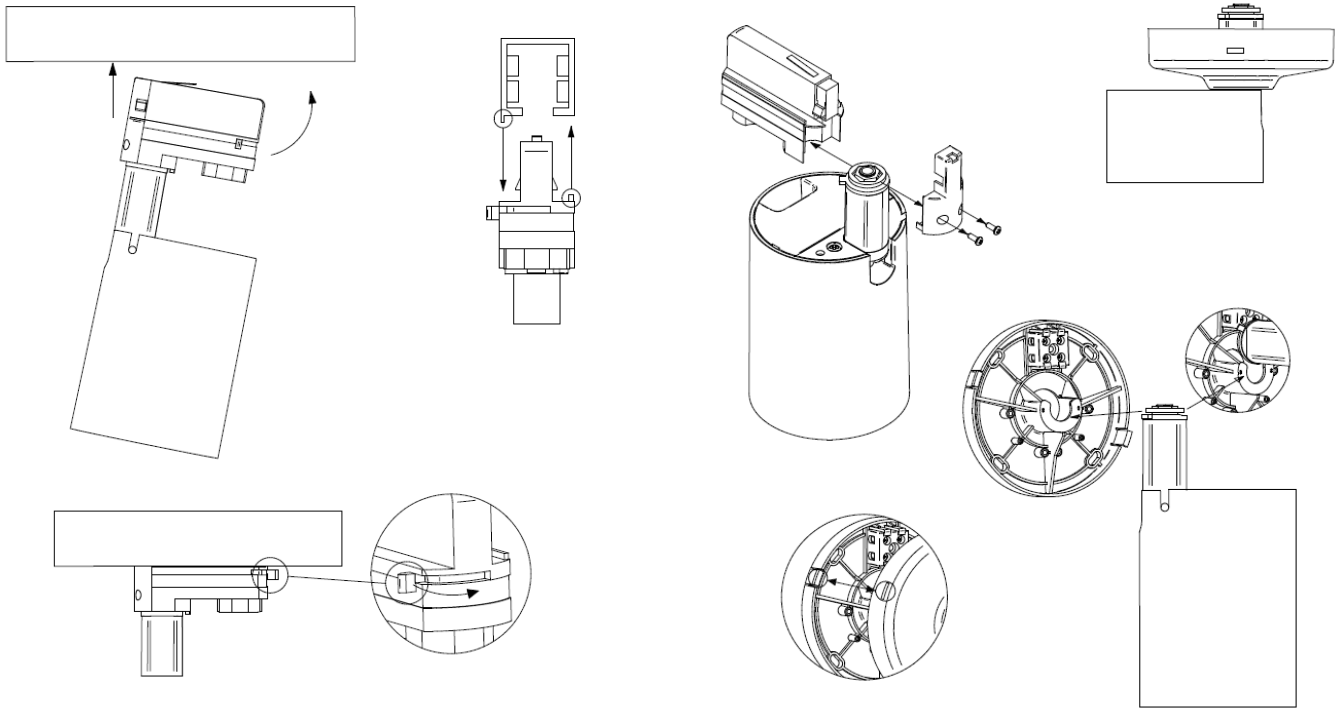

**Rail mount accessory**

**Surface mount accessory**

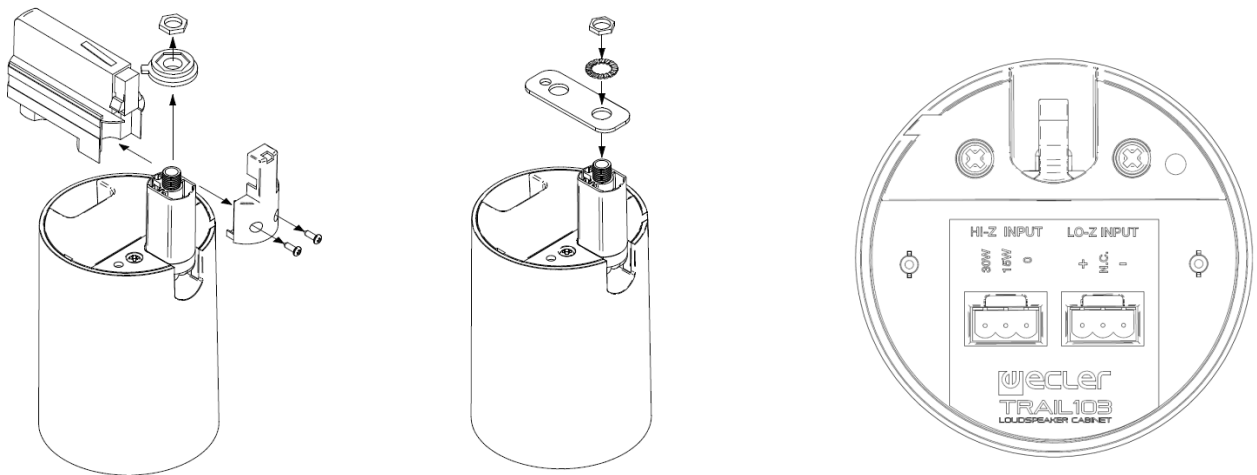

**Truss mount accessory**

**Rear panel**

POLAR DIAGRAMS

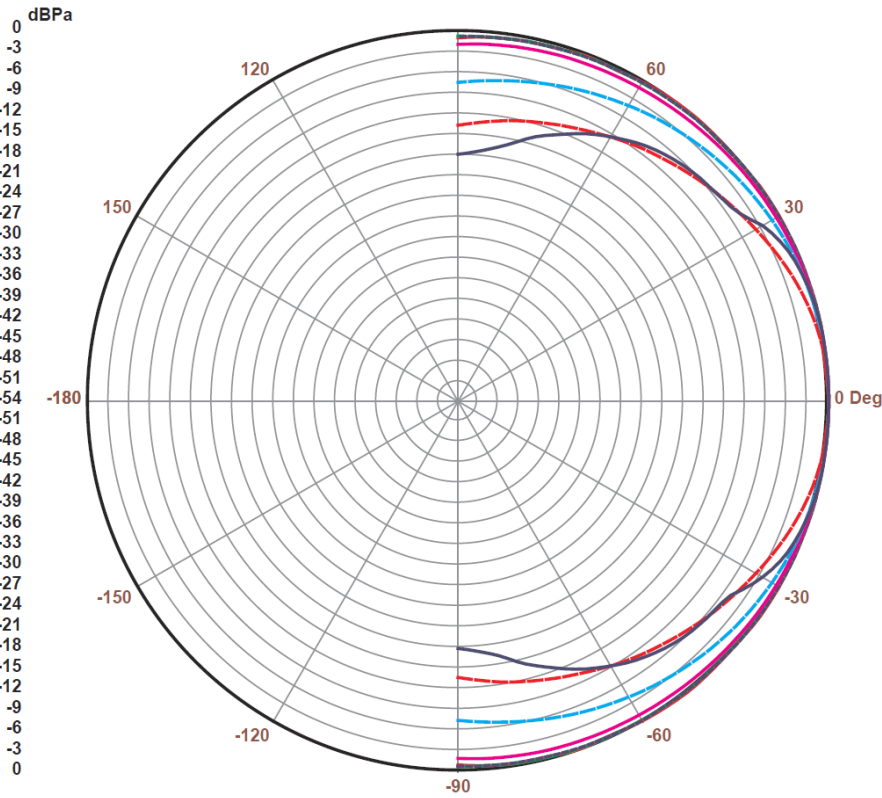

Curve	Freq	BW	Q	DI
<span style="color: red;">—</span>	125.00	180	2.0	3.0
<span style="color: green;">—</span>	250.00	180	2.0	3.0
<span style="color: darkblue;">—</span>	500.00	180	2.0	3.0
<span style="color: magenta;">—</span>	1.00K	180	2.0	3.0
<span style="color: cyan;">—</span>	2.00K	147	2.4	3.9
<span style="color: orange;">—</span>	4.00K	78	4.6	6.6
<span style="color: grey;">—</span>	8.00K	82	4.4	6.4

All product characteristics are subject to variation due to production tolerances. NEEC AUDIO BARCELONA S.L. reserves the right to make changes or improvements in the design or manufacturing that may affect these product specifications.  
 Motors, 166-168 08038 Barcelona - Spain - (+34) 932238403 [information@ecler.es](mailto:information@ecler.es) [www.ecler.com](http://www.ecler.com)